



Thread Standards

Thread	Measurements	Connection	Ø (mm)	L (mm)
Hose Connection Standard hose bard for hose clamp		6.3 mm (1/4") - 8 mm (5/16") - 10 mm (3/8") - 13 mm (1/2") - 18 mm (5/8") -	-	18.0 18.0 21.0 21.0 21.0
Stream-Line Connection Hose bard with nut cap for reusable and safe hose clamping		5 x 8 mm 6.5 x 10 mm 8 x 12 mm 9.5 x 13.5 mm 11 x 16 mm	-	15.0 17.0 19.0 21.0 25.0
CEJN-Lock Connection For special non-clamping hose		1/4" 3/8" 1/2"	-	19.0 23.0 26.0
UNF Thread Connection Unified threads according to ISO 68, ANSI B1.1		Male Thread 7/16"-20 UNF 7/8"-14 UNF	11.0 22.0	13.3 15.5
Male: ie. 9/16"-18 UNF				
Female: ie. 7/16"-20 UNF		Female Thread 7/16"-20 UNF 9/16"-18 UNF 3/4"-16 UNF 1 1/16"-16 UNF 1 5/16"-12 UNF	9.8 12.9 17.5 26.8 33.1	11.5 12.7 14.3 19.0 19.0
Female, SEA O-Ring Boss				

Metric Thread Connection

Metric threads according to ISO 68/ISO 724

Male:
 ie. M16x1.5

Female:
 ie. M16x1.5

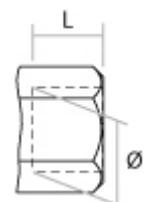
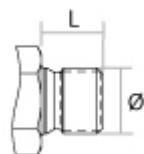

Male Thread

M10x1.25	9.8	9.0
M12x1.5	11.85	13.0
M14x1.5	13.85	13.0
M16x1.5	15.85	8.81
M22x1.5	21.85	15.7

Female Thread

M16x1.5	14.5	9.0
---------	------	-----

R/Rc Thread Connection

Conical Pipe Thread Connection
 According to ISO 7/1
 (other common descriptions are BSPT, Kr)

Male:
 ie. R 1/4"

Female:
 ie. Rp 1/4" (parallel)
 ie. Rc 1/4" (taper)

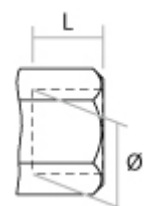
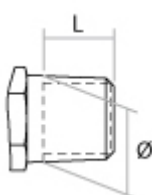

Male Thread

R 1/8"	10.2	7.4
R 1/4"	13.6	11.0
R 3/8"	17.2	11.0
R 1/2"	21.7	15.0
R 3/4"	27.1	16.3

Female Thread

Rc 1/8"	8.3	7.4
Rc 1/4"	11.0	11.0
Rc 3/8"	14.5	11.4
Rc 1/2"	18.0	15.0
Rc 3/4"	23.5	16.3

G Thread Connection

Cylindrical Pipe Thread Connection
 According to ISO 228/1
 (other common descriptions are BSP, R)

Male:
 ie. G 1/4"

Female (ISO 1179):
 ie. G 1/4"

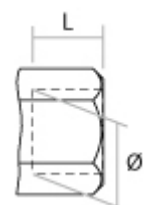
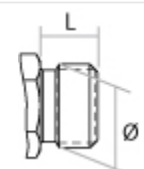

Male Thread

G 1/8"	9.6	8.0
G 1/4"	13.0	10.0
G 3/8"	16.5	10.0
G 1/2"	20.8	12.0
G 3/4"	26.3	12.0

Female Thread

G 1/8"	8.75	7.4
G 1/4"	11.8	11.0
G 3/8"	15.25	11.4
G 1/2"	19.0	15.0
G 3/4"	24.5	16.3

NPT Thread Connection

National Pipe Thread American Standard
 According to ANSI/ASME B 1.20.1

Male:
 ie. 1/4" NPT

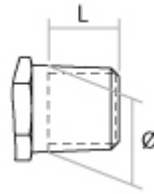

Male Thread

1/8" NPT	10.5	6.7
1/4" NPT	14.0	10.2
3/8" NPT	17.5	10.4
1/2" NPT	21.8	13.6
3/4" NPT	27.1	13.9

Female:
 ie. 1/4" NPT

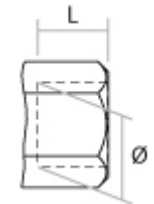

Female Thread

1/8" NPT	8.5	6.9
1/4" NPT	11.0	10.0
3/8" NPT	14.5	10.3
1/2" NPT	18.0	13.6
3/4" NPT	23.0	14.1